

GREEN LION

USER MANUAL



WIRELESS MIC

Packing List



- Package Contents:**
 1. Microphone Transmitter x2 6. Earphone X2
 2. Receiver x1
 3. Charging Case x1
 4. Charging Cable X1
 5. User Manual X1
 7. Remote

Function introduction

1. Charging case



- ① Battery indicator: when charging the charging case, the number on battery display will change base on the battery status
- ② Type C Charging Interface

Note:
 The product does not support fast charging. Please use 5V 1A power adapter to charge the product. If the rated power is exceeded, it will easily cause failure. (The product does not include a power adapter)

2. Receiver

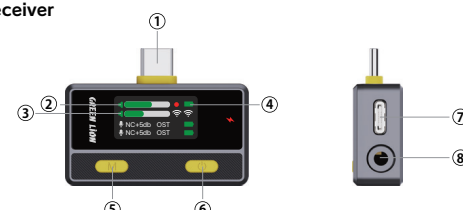

- ① Type-C connect port to smartphone
- ② MIC 1 indicator: Display volum, recording mode, noise reduction depth and signal strength
- ③ MIC 2 indicator: Display volum, recording mode, noise reduction depth and signal strength
- ④ Receiver battery indicator: Green light remains on continuously when turned on, red light stays on during charging, and turns off when fully charged.
- ⑤ Mode button: switch between Two-way & One -Way Monitoring Mode. One - way Monitoring Mode: Short press Mode Button once, red light appears on the display, will only hear own voice. Short press Mode Button again to turn back to Two-way Monitoring Mode, red light will go off, will be able to hear MIC 1 & MIC 2 both voice.
- ⑥ Power button: Short press once to turn on the receiver.
- ⑦ 3.5mm jack port to connect digital camera
- ⑧ Type-C charging port

3. Transmitter



- ① Rec/Mute/Charging indicator light
- ② Noise reduction/Bluetooth indicator
- ③ "+" button
 Long press: Mute microphone, Long press again to exit mute mode. Short press: to add microphone volum, there will be a voice prompt for reaching maximum volum.
- ④ Power/mode button
 Long press: to turn on/off the transmitter
 Short press: to switch between OST/ KTV+NOISE REDUCTION mode
 Short press twice: to turn off Noise reduction mode, short press twice again to turn on again.
- ⑤ "-" button
 Long press : turn on bluetooth function, long press again to turn off
 Short press: to lower microphone volum there will be a voice prompt for reaching minimum volum.
- ⑥ Type-C charging port
- ⑦ 3.5mm audio port for earphone

Light design for Transmitter

Light	Status	Light Method
Indicator light 1	Unconnected	Green light continously on
	Connected	Green light flash slow
	Noise reduction mode on	Green light continously on
	Noise reduction mode off	fluorescent yellow light continously on
Indicator light 2	Charging mode	Orange light continously on
	Unconnected	Green light continously on
	Bluetooth mode off	Green light flash slow
	Bluetooth waiting to pair	Green light continously on
	Bluetooth paired	fluorescent yellow light continously on
	OST mode on	Orange light continously on
KTV mode on	white light continously on (light blue light continously on under bluetooth mode)	

3. Remote

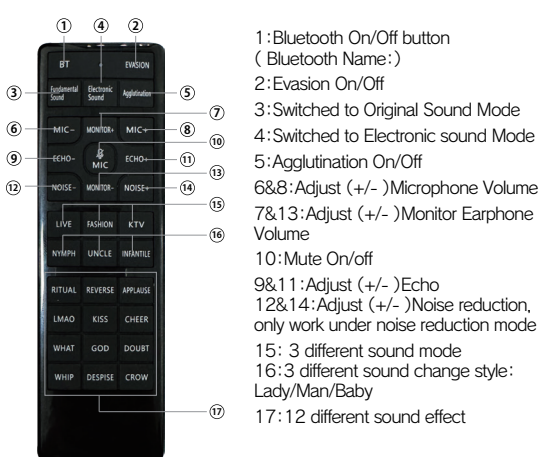

- 1: Bluetooth On/Off button (Bluetooth Name:)
- 2: Evasion On/Off
- 3: Switched to Original Sound Mode
- 4: Switched to Electronic sound Mode
- 5: Agglutination On/Off
- 6&8: Adjust (+/-) Microphone Volume
- 7&13: Adjust (+/-) Monitor Earphone Volume
- 10: Mute On/off
- 9&11: Adjust (+/-) Echo
- 12&14: Adjust (+/-) Noise reduction, only work under noise reduction mode
- 15: 3 different sound mode
- 16: 3 different sound change style: Lady/Man/Baby
- 17: 12 different sound effect

How to use

Use with smartphone

Step 1: Long press the power button on receiver and transmitter to turn on the device. Connection light indicator turns continuously on green and status light of mic appears on receiver, means successfully paired.

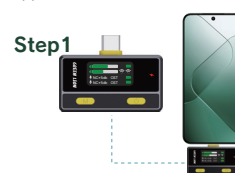

Step 2: Connect the receiver to smartphone through the connector port.



Step 3: Turn on the camera or recorder on your phone, then ready to shoot.

Use with camera

Step 1: Long press the power button on receiver and transmitter to turn on the device. Connection light indicator turns continuously on green and status light of mic appears on receiver, means successfully paired.

Step 2: Connect the receiver to the camera through the 3.5mm port.



Notes:
 How to repair again transmitter with receiver one by one when accidentally disconnected.

- Under unconnected mode, Quick press 4 times to repair with Transmitter 1 .
- Turn on the Transmitter 1 , quick press Mode Button 4 times, green light will flash fast, then will start repair automactilly. Turn if off after repaired.
- Under unconnected mode, Quick press 5 times to repair with Transmitter 2 .
- Turn on the Transmitter 2 , quick press Mode Button 4 times, green light will flash fast, then will start repair automactilly.

Specification

Frequency: 2.4Ghz Digital Frequency
 Frequency response: 20Hz-20kHz
 Sampling frequency: 48kHz
 Transmission range: up to 50m(w/o any obstacle)
 Signal to noise ratio: >= 75dB
 Sensitivity: -38dB±3dB
 Battery capacity: 1000mAh(Charging case), 180mAh(Transmitter)
 Working duration: up to 8h

GREEN LION

USER MANUAL



WIRELESS MIC

Packing List



- Package Contents:**
 1. Microphone Transmitter x2 6. Earphone X2
 2. Receiver x1
 3. Charging Case x1 7. Remote
 4. Charging Cable X1 8. 3.5mm Cable
 5. User Manual X1

Function introduction

1. Charging case



- ① Battery indicator: when charging the charging case, the number on battery display will change base on the battery status
- ② Type C Charging Interface

Note:
 The product does not support fast charging. Please use 5V 1A power adapter to charge the product. If the rated power is exceeded, it will easily cause failure. (The product does not include a power adapter)

2. Receiver

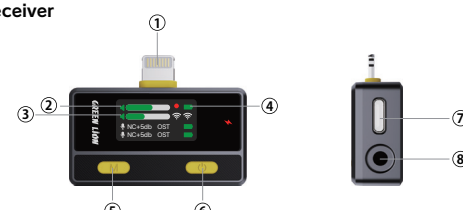

- ① Lightening connect port to smartphone
- ② MIC 1 indicator: Display volum, recording mode, noise reduction depth and signal strength
- ③ MIC 2 indicator: Display volum, recording mode, noise reduction depth and signal strength
- ④ Receiver battery indicator: Green light remains on continuously when turned on, red light stays on during charging, and turns off when fully charged.
- ⑤ Mode button: switch between Two-way & One -Way Monitoring Mode. One - way Monitoring Mode: Short press Mode Button once, red light appears on the display, will only hear own voice. Short press Mode Button again to turn back to Two-way Monitoring Mode, red light will go off, will be able to hear MIC 1 & MIC 2 both voice.
- ⑥ Power button: Short press once to turn on the receiver.
- ⑦ 3.5mm jack port to connect digital camera
- ⑧ Type-C charging port

3. Transmitter

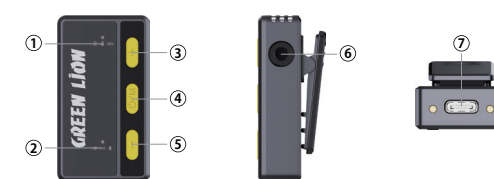

- ① Rec/Mute/Charging indicator light
- ② Noise reduction/Bluetooth indicator
- ③ "+" button
 Long press: Mute microphone, Long press again to exit mute mode. Short press: to add microphone volum, there will be a voice prompt for reaching maximum volum.
- ④ Power/mode button
 Long press: to turn on/off the transmitter
 Short press: to switch between OST/ KTV+NOISE REDUCTION mode
 Short press twice: to turn off Noise reduction mode, short press twice again to turn on again.
- ⑤ "-" button
 Long press : turn on bluetooth function, long press again to turn off
 Short press: to lower microphone volum there will be a voice prompt for reaching minimum volum.
- ⑥ Type-C charging port
- ⑦ 3.5mm audio port for earphone

Light design for Transmitter

Light	Status	Light Method
Indicator light 1	Unconnected	Green light continously on
	Connected	Green light flash slow
	Noise reduction mode on	Green light continously on
	Noise reduction mode off	fluorescent yellow light continously on
Indicator light 2	Charging mode	Orange light continously on
	Unconnected	Green light continously on
	Bluetooth mode off	Green light flash slow
	Bluetooth waiting to pair	Green light continously on
	Bluetooth paired	fluorescent yellow light continously on
	OST mode on	Orange light continously on
KTV mode on	white light continously on (light blue light continously on under bluetooth mode)	

3. Remote

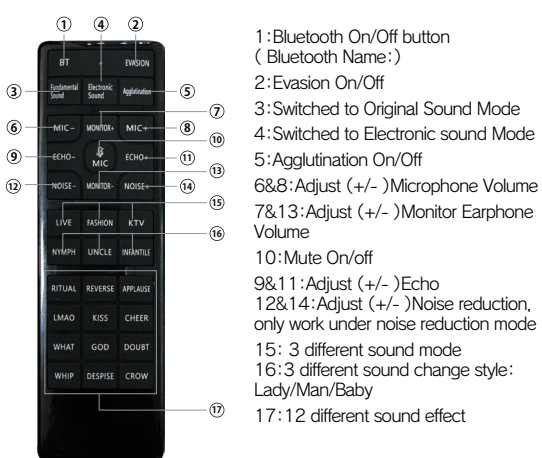

- 1: Bluetooth On/Off button (Bluetooth Name:)
- 2: Evasion On/Off
- 3: Switched to Original Sound Mode
- 4: Switched to Electronic sound Mode
- 5: Agglutination On/Off
- 6&8: Adjust (+/-) Microphone Volume
- 7&13: Adjust (+/-) Monitor Earphone Volume
- 10: Mute On/off
- 9&11: Adjust (+/-) Echo
- 12&14: Adjust (+/-) Noise reduction, only work under noise reduction mode
- 15: 3 different sound mode
- 16: 3 different sound change style: Lady/Man/Baby
- 17: 12 different sound effect

How to use

Use with smartphone

Step 1: Long press the power button on receiver and transmitter to turn on the device. Connection light indicator turns continuously on green and status light of mic appears on receiver, means successfully paired.



Step 2: Connect the receiver to smartphone through the connector port.



Step 3: Turn on the camera or recorder on your phone, then ready to shoot.

Use with camera

Step 1: Long press the power button on receiver and transmitter to turn on the device. Connection light indicator turns continuously on green and status light of mic appears on receiver, means successfully paired.

Step 2: Connect the receiver to the camera through the 3.5mm port.



Notes:
 How to repair again transmitter with receiver one by one when accidentally disconnected.

- Under unconnected mode, Quick press 4 times to repair with Transmitter 1 .
- Turn on the Transmitter 1 , quick press Mode Button 4 times, green light will flash fast, then will start repair automactilly. Turn if off after repaired.
- Under unconnected mode, Quick press 5 times to repair with Transmitter 2 .
- Turn on the Transmitter 2 , quick press Mode Button 4 times, green light will flash fast, then will start repair automactilly.

Specification

Frequency: 2.4Ghz Digital Frequency
 Frequency response: 20Hz-20kHz
 Sampling frequency: 48kHz
 Transmission range: up to 50m(w/o any obstacle)
 Signal to noise ratio: >= 75dB
 Sensitivity: -38dB±3dB
 Battery capacity: 1000mAh(Charging case), 180mAh(Transmitter)
 Working duration: up to 8h